

TOWN OF BROOKLYN

**Resolution for Ward Creation, Designation of Polling Place,
and Combining Wards for Elections**

WHEREAS, the Brooklyn Town Board, County of Green, Wisconsin, is responsible for ward creation in the Town of Brooklyn.

NOW, THEREFORE, BE IT RESOLVED by the Brooklyn Town Board, Green County, Wisconsin, that the Town of Brooklyn will be divided into three wards as indicated on the attached map, also described as follows:

Ward 1: All of the territory within the boundaries of the Town of Brooklyn lying north and east of the center line of Behnke Road, Sandy Hook Road, Zweifel Road, County Highway E, and Elmer Road.

Ward 1 description by Census Tract and Block Number:

Part of Tract 960100, Blocks:	1006-1012
	1020-1053
	1060
	1071
	1075
	2000
	2060-2061

Ward 2: All of the territory within the boundaries of the Town of Brooklyn lying south and west of the center line of Behnke Road, Sandy Hook Road, Zweifel Road, and County Highway E.

Ward 2 description by Census Tract and Block Number:

Part of Tract 960100, Blocks:	1054-1057
	1061-1066
	2062-2067
	4011-4016
	4042

Ward 3: All of the territory within the boundaries of the Town of Brooklyn lying south and east of the center line of Elmer Road and County Highway E.

Ward 3 description by Census Tract and Block Number:

Part of Tract 960100, Blocks:	1058-1059
	1067-1070
	1072-1073

BE IT FURTHER RESOLVED by the Brooklyn Town Board, Green County, Wisconsin, that the Brooklyn Town Hall, 400 Main Street, Brooklyn, Wisconsin, be designated as the polling place for all voters in Ward 1, Ward 2 and Ward 3 in the Town of Brooklyn.

BE IT FURTHER RESOLVED by the Brooklyn Town Board, Green County, Wisconsin, that Ward 1, Ward 2 and Ward 3 be combined for voting purposes.

SIGNED: TOWN CHAIR



Ted Belanus

ATTEST:

I, Melinda Carr, Town Clerk, in and for the Town of Brooklyn, do hereby certify that the above and foregoing is a true and correct copy of the Resolution adopted by the Brooklyn Town Board on 13th day of June, 2011.

Dated at the Town of Brooklyn, Green County, Wisconsin, this 13th day of June, 2011.



Melinda Carr
Brooklyn Town Clerk

Town of Brooklyn

Ward 1 - North and east of Behnke, Sandy Hook, Zweifel, CTHE, Elmer Roads.

Ward 2 - South and west of Behnke, Sandy Hook, Zweifel and CTHE.

Ward 3 - South and east of Elmer Road and CTHE.

Brooklyn

T.4-3N. - R.9E.

©2004 cloud cartographics, Inc. cloud.mif 46301

Dane County

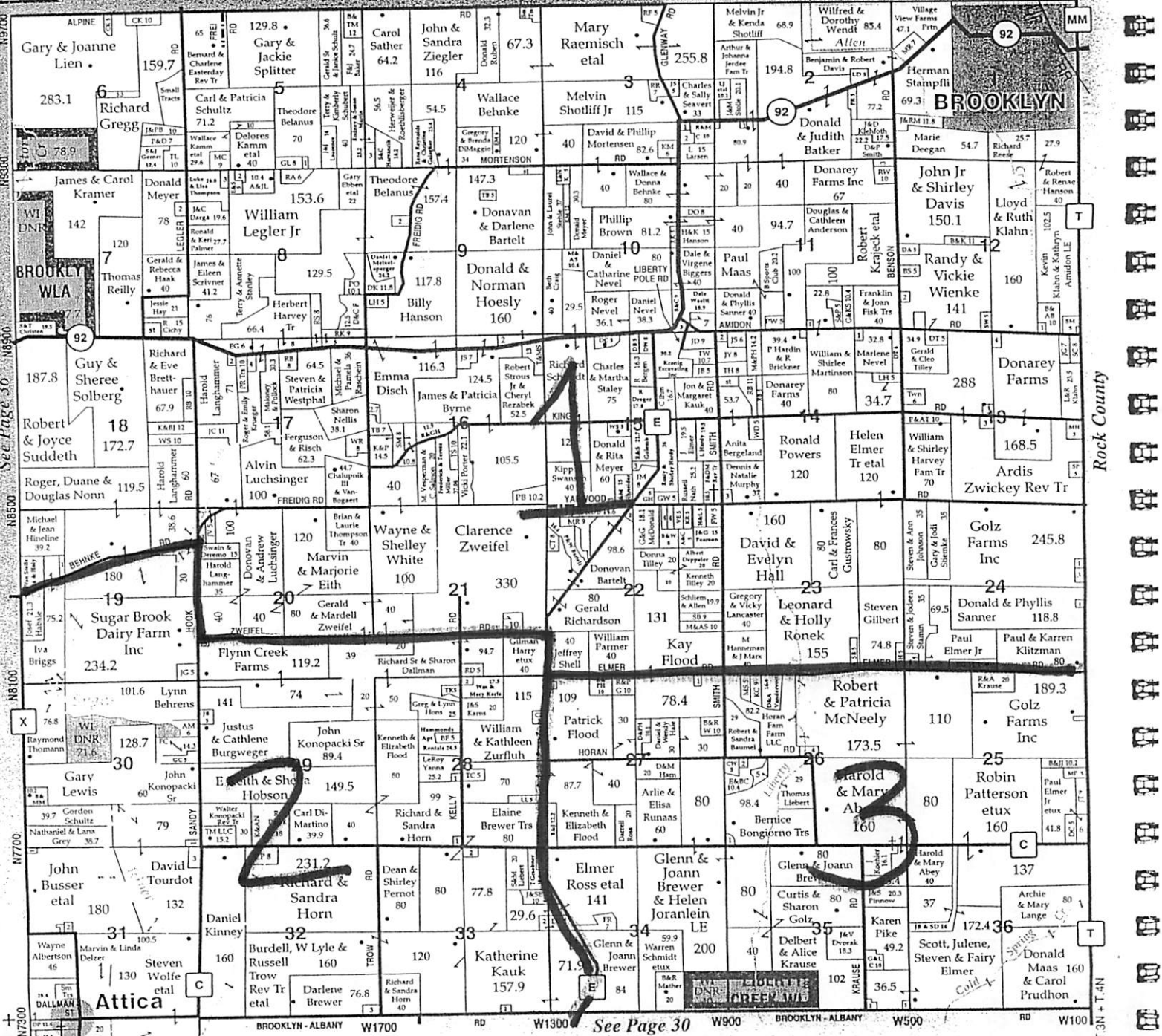

Vertical text on the left margin: N19700, N18700, N18500, N18300, N18100, N17900, N17700, N17500, N17300, N17100, N16900, N16700, N16500, N16300, N16100, N15900, N15700, N15500, N15300, N15100, N14900, N14700, N14500, N14300, N14100, N13900, N13700, N13500, N13300, N13100, N12900, N12700, N12500, N12300, N12100, N11900, N11700, N11500, N11300, N11100, N10900, N10700, N10500, N10300, N10100, N9900, N9700, N9500, N9300, N9100, N8900, N8700, N8500, N8300, N8100, N7900, N7700, N7500, N7300, N7100, N6900, N6700, N6500, N6300, N6100, N5900, N5700, N5500, N5300, N5100, N4900, N4700, N4500, N4300, N4100, N3900, N3700, N3500, N3300, N3100, N2900, N2700, N2500, N2300, N2100, N1900, N1700, N1500, N1300, N1100, N900, N700, N500, N300, N100.

Rock County

See Page 30

Horizontal text at the bottom: W2500, W2100, W1700, W1300, W900, W500, W100. Vertical text on the right: T.4N, T.3N, T.2N, T.1N.

